

FILE: EL CAMINO AT MILLBRAE AV.

Subject: ANOTHER records request - Millbrae and Menlo Park - date filed 9-5-14

From: [REDACTED]

Date: Fri, 05 Sep 2014 16:53:54 -0700

To: heidemarie.carle@dot.ca.gov

9-5-14

For Ms. Carle -

Here is a new public records request.

1. Please provide a copy of the speed survey for Bayfront near Chilco, in Menlo Park.
2. Please provided a copy of the justification for the current red light camera encroachment permit issued to the City of Menlo Park.
3. Please provide a copy of all current issued encroachment permits for red light cameras in Millbrae. Please also include the justification the City provided.

Thanks,

Jim [REDACTED]

--

[REDACTED]

DEPARTMENT OF TRANSPORTATION
OFFICE OF PUBLIC AFFAIRS
111 Grand Avenue
P. O. BOX 23660
Oakland, CA 94623-0660
PHONE (510) 286-6445
FAX (510) 286-6299



*Severe drought!
Save on water!*

October 2, 2014

Jim [REDACTED]
[REDACTED]
[REDACTED]

RE: CPRA 04-5938

Dear Mr. [REDACTED]

This letter is in response to your request of September 5, 2014, and received on September 8, 2014, to the California Department of Transportation (Department), pursuant to the California Public Records Act (CPRA; Government Code Sections 6250-6276).

Enclosed are records responsive to Item #2 and Item #3 of your request. Records responsive to Item #1 were sent to you previously by email on September 18, 2014.

The Department believes this to be the full and complete response to your request and comprises all documentation that can be produced at this time. Please contact me at (510) 622-0799 or heidemarie.carle@dot.ca.gov if you need any further assistance or have questions regarding your request.

Sincerely,

A handwritten signature in black ink, appearing to read "Heidemarie Carle".

Heidemarie Carle
Public Information Officer
District 4 CPRA Coordinator

Enclosures (3)

CAC

SEP 14 2009

Page 1 of 4

STATE OF CALIFORNIA • DEPARTMENT OF TRANSPORTATION

STANDARD ENCROACHMENT PERMIT APPLICATION

TR-0100 (REV. 05/2006)

Permission is requested to encroach on the State highway right-of-way as follows: (Complete all BOXES [write N/A if not applicable])

This application is not complete until all requirements have been approved.

FOR CALTRANS USE

PERMIT NO. 0407-NSN 1361

DIST./COR/RT/E/PM 04-SM-82 16.0

SIMPLEX STAMP

040707 1361

SN

DATE OF SIMPLEX STAMP AUG 28 2007

1. COUNTY San Mateo 2. ROUTE 82 3. POSTMILE 16.0

4. ADDRESS OR STREET NAME El Camino Real @ Millbrae Avenue 5. CITY Millbrae

6. CROSS STREET (Distance and direction from site) Millbrae Avenue 7. PORTION OF RIGHT-OF-WAY Intersection

8. WORK TO BE PERFORMED BY [] OWN FORCES [X] CONTRACTOR 9. EST. START DATE August 1, 2007 10. EST. COMPLETION DATE October 31, 2007

11. EXCAVATION MAX. DEPTH 5 Feet AVG. DEPTH 4 Feet AVG. WIDTH 2 Feet LENGTH 2 Feet SURFACE TYPE Asphalt Concrete 12. EST. COST IN STATE R/W \$50,000

13. PIPES PRODUCT TYPE N/A DIAMETER N/A VOLTAGE / PSIG N/A 14. CALTRANS PROJECT E.A. NUMBER N/A

15. [] Double Permit Parent Permit Number _____

Applicant's Reference Number / Utility Work Order Number _____

16. Have your plans been reviewed by another Caltrans branch? NO [X] YES [] (If "YES" Who? _____)

17. Completely describe work to be done within STATE highway right-of-way :

Attach 6 complete sets of FOLDED plans (folded 8.5" x 11"), and any applicable specifications, calculations, maps, etc. All dimensions shall be in U.S. Customary (English) Units.

Install red light camera enforcement for southbound El Camino Real to eastbound Millbrae Avenue approach. A 20-foot pole with flash light and camera will be installed in the sidewalk area on southbound El Camino Real. A 10-foot pole with flash light and camera will also be installed in the sidewalk area at the southeast corner of the subject intersection. All associated conduit and conductors will also be installed in conjunction with the project.

Handwritten signature and notes: CAC/3, coordinated w/ Lalji

18. Is a city, county, or other agency involved in the approval of this project?

[X] YES (If "YES", check type of project and attach environmental documentation and conditions of approval.)

[] COMMERCIAL DEVELOPMENT [] BUILDING [] GRADING [X] OTHER Traffic Safety

[X] CATEGORICALLY EXEMPT [] NEGATIVE DECLARATION [] ENVIRONMENTAL IMPACT REPORT [] OTHER _____

[] NO (If "NO", please check the category below which best describes the project, and complete page 4 of this application.)

[] DRIVEWAY OR ROAD APPROACH, RECONSTRUCTION, MAINTENANCE, OR RESURFACING [] FENCE

[] PUBLIC UTILITY MODIFICATIONS, EXTENSIONS, HOOKUPS [] MAILBOX

[] FLAGS, SIGNS, BANNERS, DECORATIONS, PARADES AND CELEBRATIONS [] EROSION CONTROL

[] OTHER _____ [] LANDSCAPING

19. Will this project cause a substantial change in the significance of a historical resource (45 years or older), or cultural resource? [] YES [X] NO (If "YES", provide a description)

20. Is this project on an existing highway or street where the activity involves removal of a scenic resource including a significant tree or stand of trees, a rock outcropping or a historic building? [] YES [X] NO (If "YES", provide a description)

21. Is work being done on applicant's property? [X] YES [] NO (If "YES", attach site and grading plans.)

PERMIT NO. _____

22. Will this proposed project require the disturbance of soil within highway right-of-way? YES NO
 If "YES", estimate the area in square feet AND acres: _____ (ff)
 _____ (acres)

23. Will this proposed project require dewatering? YES NO
 If "YES", estimate daily volume in gallons per day: _____ (gpd)

24. How will any storm water or ground water be disposed of from within or near the limits of this proposed project?
 Storm Drain System Combined Sewer / Storm System Storm Water Retention Basin
 Other (explain): No ground water or storm water will be encountered during the project.

PLEASE READ THE FOLLOWING CLAUSES PRIOR TO SIGNING THIS ENCROACHMENT PERMIT APPLICATION.

The applicant, understands and herein agrees to that an encroachment permit can be denied, and/or a bond required for non-payment of prior or present encroachment permit fees. Encroachment Permit fees may still be due when an application is withdrawn or denied, and that a denial may be appealed, in accordance with the California Streets and Highways Code, Section 671.5. All work shall be done in accordance with Caltrans rules and regulations subject to inspection and approval.

The applicant, understands and herein agrees to the general provisions, special provisions and conditions of the encroachment permit, and to indemnify and hold harmless the State, its officers, directors, agents, employees and each of them (Indemnitees) from and against any and all claims, demands, causes of action, damages, costs, expenses, actual attorneys' fees, judgments, losses and liabilities of every kind and nature whatsoever (Claims) arising out of or in connection with the issuance and/or use of this encroachment permit for: 1) bodily injury and/or death to persons including but not limited to the Applicant, the State and its officers, directors, agents and employees, the Indemnitees, and the public; and 2) damage to property of anyone. Except as provided by law, the indemnification provisions stated above shall apply regardless of the existence or degree of fault of Indemnitees. The Applicant, however, shall not be obligated to indemnify Indemnitees for Claims arising from conduct delineated in Civil Code Section 2782.

DISCHARGES OF STORM WATER AND NON-STORM WATER: Work within State highway right-of-way shall be conducted in compliance with all applicable requirements of the National Pollutant Discharge Elimination System (NPDES) permit issued to the Department of Transportation (Department), to govern the discharge of storm water and non-storm water from its properties. Work shall also be in compliance with all other applicable Federal, State and Local laws and regulations, and with the Department's Encroachment Permits Manual and encroachment permit. Compliance with the Departments NPDES permit requires amongst other things, the preparation and submission of a Storm Water Pollution Protection Plan (SWPPP), or a Water Pollution Control Program (WPCP), and the approval of same by the appropriate reviewing authority prior to the start of any work. Information on the requirements may also be reviewed on the Department's Construction Website at:

<http://www.dot.ca.gov/hq/construc/stormwater1.htm>

25. NAME of APPLICANT or ORGANIZATION (Print or Type) City of Millbrae	E-MAIL ADDRESS klim@ci.millbrae.ca.us
---	--

ADDRESS of APPLICANT or ORGANIZATION WHERE PERMIT IS TO BE MAILED (Include City and Zip Code)
 621 Magnolia Avenue, Millbrae, CA 94030

PHONE NUMBER (650) 259-2347	FAX NUMBER (650) 697-8158
--------------------------------	------------------------------

26. NAME of AUTHORIZED AGENT / ENGINEER (Print or Type) Khee Lim	IS LETTER OF AUTHORIZATION ATTACHED? <input type="checkbox"/> YES <input checked="" type="checkbox"/> NO	E-MAIL ADDRESS
---	---	----------------

ADDRESS of AUTHORIZED AGENT / ENGINEER (Include City and Zip Code)
 621 Magnolia Avenue, Millbrae, CA 94030

PHONE NUMBER (650) 259-2347	FAX NUMBER (650) 697-8158
--------------------------------	------------------------------

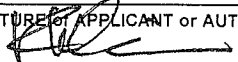
27. SIGNATURE of APPLICANT or AUTHORIZED AGENT 	28. PRINT OR TYPE NAME Khee Lim	29. TITLE City Engineer	30. DATE May 31, 2007
---	------------------------------------	----------------------------	--------------------------

*Resubmitted
8-1-2007*

PERMIT NO.
0407-NSN 1361

FEE CALCULATION -- FOR CALTRANS USE					
<input type="checkbox"/> CASH <input type="checkbox"/> CREDIT CARD NAME ON CARD _____ PHONE NUMBER _____					
<input type="checkbox"/> CHECK NUMBER _____ NAME ON CHECK _____ PHONE NUMBER _____					
<input checked="" type="checkbox"/> EXEMPT <input type="checkbox"/> PROJECT EA _____ <input type="checkbox"/> DEFERRED BILLING (Utility)					
CALCULATED BY	(1)		(2)		
REVIEW	1. FEE / DEPOSIT	DATE	2. FEE / DEPOSIT	DATE	TOTAL FEE / DEPOSIT
1. _____ HOURS @ \$ _____ *	\$ _____		\$ _____		\$ _____
2. _____ HOURS @ \$ _____ *					\$ _____
INSPECTION	1. FEE / DEPOSIT	DATE	2. FEE / DEPOSIT	DATE	TOTAL FEE / DEPOSIT
1. _____ HOURS @ \$ _____ *	\$ _____		\$ _____		\$ _____
2. _____ HOURS @ \$ _____ *					\$ _____
FIELD WORK					
_____ HOURS @ \$ _____ *	\$ _____		\$ _____		\$ _____
EQUIPMENT & MATERIALS	DEPOSIT	DATE	DEPOSIT	DATE	DEPOSIT
	\$ _____		\$ _____		\$ _____
CASH DEPOSIT IN LIEU OF BOND	\$ _____		\$ _____		\$ _____
TOTAL COLLECTED	\$ _____		\$ _____		
CASHIER'S INITIALS	_____		\$ _____		
* The current hourly rate is set annually by Headquarters Accounting. District Office staff do not have authority to modify this rate.					
PERFORMANCE BOND	<input type="checkbox"/>	DATE			AMOUNT \$
PAYMENT BOND	<input type="checkbox"/>	DATE			AMOUNT \$
LIABILITY INSURANCE REQUIRED?	<input type="checkbox"/> YES <input type="checkbox"/> NO				AMOUNT \$

INSTRUCTIONS
for completing page 4

This page needs to be completed when the proposed project **DOES NOT** involve a City, County or other public agency.

Your answers to these questions will assist departmental staff in identifying any physical, biological, social or economic resources that may be affected by your proposed project within the State highway right-of-way. And, to determine which type of environmental studies may be required to approve your application for an encroachment permit.

It is the applicant's responsibility for the production of all required environmental documentation and supporting studies, in some cases this may be costly and time-consuming. If possible, attach photographs of the location of the proposed project.

Please answer these questions to the best of your ability. Provide a description of any "YES" answers (type, name, number, etc.)

-
1. Will any existing vegetation and/or landscaping within the highway right-of-way be disturbed?

 2. Will the proposed project involve any soil disturbance within highway right-of-way (trenching or excavation)?

 3. Are there waterways (river, creek, pond, natural pool or dry streambed) adjacent to or within the limits of the project or highway right-of-way?

 4. Is the proposed project located within five miles of the coast line?

 5. Will the proposed project generate construction noise levels greater than 86 dBA (i.e. jack-hammering, pile driving)?

 6. Will the proposed project incorporate land from a public park, recreation area or wildlife refuge open to the public?

 7. Are there any recreational trails or paths within the limits of the proposed project or highway right-of-way?

 8. Will the proposed project impact any structures, buildings, rail lines, or bridges within highway right-of-way?

 9. Will the proposed project impact access to any businesses or residences?

 10. Will the proposed project impact any existing public utilities or public services?

 11. Will the proposed project impact existing pedestrian facilities, such as sidewalks, crosswalks, or overcrossings?

 12. Will new lighting be constructed within or adjacent to highway right-of-way?



Millbrae Police Department

551 Magnolia Avenue • Millbrae, California 94030
650.259.2300 Fax 650.259.2349



November 6, 2007

Caltrans District 4
111 Grand Avenue
Oakland, Ca. 94612

Dear Sir or Madam:

The City of Millbrae is the second City in San Mateo County to have a red light photo enforcement program. Currently, the City's largest and busiest intersection is equipped with this technology. In the first year of the red light photo enforcement program we have experienced a drastic reduction in red light violations and vehicle collisions at this intersection.

The City of Millbrae is preparing for expansion of this program to two additional intersections. One of these intersections is the south bound Hwy 101/Millbrae Avenue off-ramp. Statistical data compiled by our current vendor as well as frequent vehicle collisions in this area support the need for enforcement at this location. By implementing red light photo enforcement at this intersection, we are committed to ensuring public safety and reducing violation and collision rates. Our ultimate objective is to make this intersection even safer for the daily commuters and general public.

Approach Monitored	# Hours Monitored	Total Violations	Left Turn Violations	Turn Straight Through Violations	Right Turn Violations
EB Millbrae @ El Camino	4	2	0	0	2
SB Millbrae @ El Camino	4	8	7	0	1
Hwy 101 @ Millbrae	3.5	37	-	-	37

Collisions at E. Millbrae Ave/Hwy 101	
2004	16
2005	18
2006	3



Millbrae Police Department

251 Magnolia Avenue • Millbrae, California 94030
650.259.2300 Fax 650.259.2344

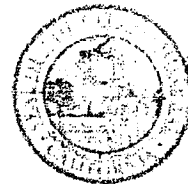

If you may have any questions please do not hesitate to contact me at 650-259-2314.

Sincerely,

A handwritten signature in black ink, appearing to read "John Aronis". The signature is fluid and cursive, with a long horizontal stroke at the end.

John Aronis
Sergeant-Millbrae Police Department
Red Light Photo Enforcement Supervisor



"Khee Lim"
<klim@ci.millbrae.ca.us>

08/20/2009 11:30 AM

Please respond to
<klim@ci.millbrae.ca.us>

To "Farshid Brojeni" <farshid_brojeni@dot.ca.gov>

cc "John Aronis" <jaronis@ci.millbrae.ca.us>

bcc

Subject Collision Diagrams

Hi Farshid,

Enclosed please find the collision diagram for Millbrae/ECR. They are a total of 9 reported accidents at the subject intersection between 2005 and 2009.

Also, I am sending you hard copies of those accidents that you told me Caltrans could not verified for the intersection of US101/Millbrae. There are a total of 14 reported accidents at the US101/Millbrae intersection. In our previous letter to you, we stated that we had 17 accidents but 3 of those accidents involved only properties damage and therefore our Police Department did not write accident reports for.

Thanks for your help.

Khee

(650) 259-2347



Millbrae Ave. at ECR Collision Diagram 2004-2009.pdf E. Millbrae Ave. at HWY 101 Collision Diagram 2004-2009.pdf

El Camino Real at
Millbrae Avenue
Collision Diagram
2005 - 2009

NO.	DESCRIPTION	BY	DATE

City of Millbrae
Public Works Department
621 Magnolia Avenue
Millbrae, CA 94030
Tel: (650) 259-2339, Fax: (650) 697-8158
www.ci.millbrae.ca.us

Date: August 2009
Scale: N/S
Design By: A. Riddell
Drawn By: A. Riddell
Checked By: K. Lim

SHEET 1 OF 1
City Project No.
N/A

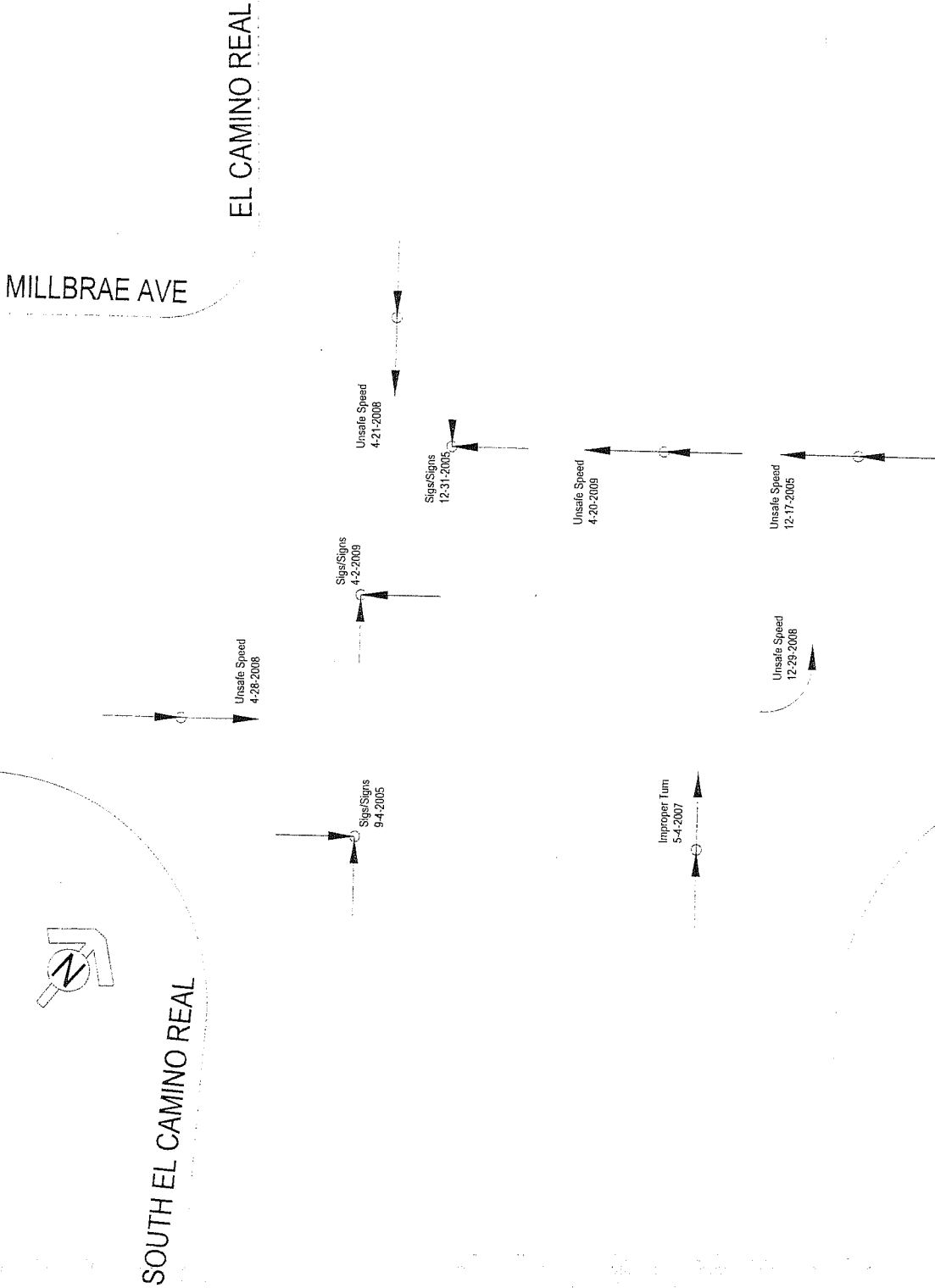

STATE OF CALIFORNIA • DEPARTMENT OF TRANSPORTATION
ENCROACHMENT PERMIT
 TR-0120

FILE

Permit No. 0407-NSN 1361	
Dist/Co/Rte/PM 04-SM- 82 16	
Date September 10, 2009	
Fee Paid \$	Deposit \$
Performance Bond Amount (1)	Payment Bond Amount (2)
Bond Company	
Bond Number (1)	Bond Number (2)

In compliance with (Check one):

Your application of August 1, 2007

Utility Notice No. _____ of _____

Agreement No. _____ of _____

R/W Contract No. _____ of _____

TO: City of Millbrae
 621 Magnolia Avenue
 Millbrae, CA 94030

Attn: Mr. Khee Lim
 Phone: (650) 259- 2347 _____ , PERMITTEE

and subject to the following, **PERMISSION IS HEREBY GRANTED** to:
 install Automated Red Light Enforcement System (ARLES), poles, flashlights , associated conduits and wirings, for the southbound El Camino Real to eastbound Millbrae Avenue approach and at the southeast corner of the intersection, on State Highway 04-SM- 82, Post Mile 16.0, in the City of Millbrae.

A minimum of one week prior to the start of work under this permit, notice shall be given to, and approval of construction details, operations, public safety, and traffic control shall be obtained from State Representative Fred Farid, 110 Rickard Street, San Francisco CA 94134,510-715-9553, weekdays,between7:30AM & 4:00PM.

All permitted work requires the permittee to apply for and obtain a work authorization number prior to the start of work. See the attached "Encroachment Permit Project Work Scheduling Procedures" and the attached "Permit Project Work Scheduling Request Form". Additional time beyond the minimum seven-day advanced notice required in the above paragraph may be required for obtaining approval.

<p>The following attachments are also included as part of this permit (Check applicable):</p> <p><input checked="" type="checkbox"/> Yes <input type="checkbox"/> No General Provisions</p> <p><input type="checkbox"/> Yes <input checked="" type="checkbox"/> No Utility Maintenance Provisions</p> <p><input type="checkbox"/> Yes <input checked="" type="checkbox"/> No Storm Water Special Previsions</p> <p><input type="checkbox"/> Yes <input checked="" type="checkbox"/> No A Cal-OSHA permit required prior to beginning work: # _____</p>	<p>In addition to fee, the permittee will be billed actual costs for:</p> <p><input type="checkbox"/> Yes <input checked="" type="checkbox"/> No Review</p> <p><input checked="" type="checkbox"/> Yes <input type="checkbox"/> No Inspection</p> <p><input checked="" type="checkbox"/> Yes ----- Field Work</p> <p>(If any Caltrans effort expended)</p>
---	--

Yes No The information in the environmental documentation has been reviewed and considered prior to approval of this permit.

This permit is void unless the work is completed before September 30, 2010

This permit is to be strictly construed and no other work other than specifically mentioned is hereby authorized. No project work shall be commenced until all other necessary permits and environmental clearances have been obtained.

CC
 CC: Bob Salazar (2), FF
 Field Elect: J. Tubon
 TMC/ J. Richardson,
 Traffic System/P. Chan

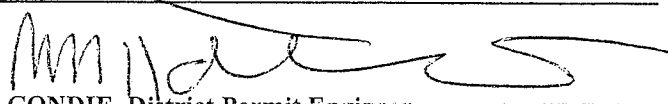
APPROVED:
BIJAN SARTIPI, District Director
 BY: 
M. D. CONDIE, District Permit Engineer

When approved, traffic control performed under this permit shall be in accordance with the appropriate State Standard Plans T-10 through T-14. Where required by the plan, the use of a flashing arrow-board is **MANDATORY**.

See attached Standard Plans T-10 and T-11. For shoulder closure, use Standard Plan T-10.

On SB 82 El Camino Real: Provide at least two through traffic lanes of travel. Monday thru Friday, between 9:00AM to 3:00PM. Holidays are excluded.

On SB 82 El Camino Real to EB Millbrae Avenue: One left turn lane may be closed. Sunday thru Thursday, between 9:00 PM to 6:00AM. Holidays are excluded.

On SB 82 El Camino Real to WB Millbrae Avenue: Provide at least two through traffic lanes of travel. Monday thru Friday, between 9:00AM to 3:00PM. Holidays are excluded.

On NB 82 El Camino Real to WB Millbrae Avenue: Left turn lane may be closed. Sunday thru Thursday, between 9:00 PM to 6:00AM. Holidays are excluded.

On both NB and SB 82 El Camino Real, provide at least one thru traffic lane from 12:00 AM to 5:00AM . Monday thru Friday. Holidays are excluded

No other lane closure is permitted at any other times.

Parking may be restricted while work is actively in progress.

The site of the work shall be enclosed by suitable barricades, signs and lights, as approved by State's representative, to warn and protect traffic effectively.

The City of Millbrae shall instruct their officers not to contact Caltrans if only the Automated Traffic Light Enforcement System (ARLES) is damaged due to an accident.

If Caltrans is called out and finds that only the red light equipment is damaged, The City of Millbrae shall reimburse Caltrans for the costs of the call-out.

The ARLES shall be powered from a separate source other than Caltrans.

Installation of additional loops is prohibited. The City of Millbrae may install wireless detection or any other method of detection that does not damage the State roadways.

Access to signal cabinet shall be performed at the presence of Caltrans Representative.

In the event of future modifications to the traffic signal by Caltrans, the City of Millbrae shall be responsible for relocation costs of the ARLES.

Caltrans will provide initial yellow interval information to the City of Millbrae for installing the ARLES upon request. Any subsequent need for verification of the yellow interval shall be the responsibility of the City of Millbrae.

The ARLES cables shall be installed in a separate conduit with distinctively marked pull boxes and no ARLES equipment shall be installed in the traffic signal controller cabinet.

Any connections to the State system shall be in the form of 24 Volt DC or less sensing unit. This unit shall not be hard wired to State conductors.

Any damage to the existing State facilities shall be repaired at permittee's expense.

All work within the State Right of Way shall conform to the ADA requirements

At least five working days before starting work on any signal or lighting facilities under this permit, State's Permit Electrical Engineer J. Tubon shall be contacted at (415) 330 -6544 for approval of construction and operational details.

A safe minimum passageway of 1.21m (4') shall be maintained through the working area at existing pedestrian or bicycle facilities. At no time shall pedestrian be diverted onto a portion of the street used for vehicular traffic. At locations where safe alternate passageways cannot be provided, appropriate signs and barricades shall be installed at the limit of construction and in advance of the limits of construction at the nearest crosswalk or intersection to detour pedestrian to facilities across the street.

Excavations made within the limits of the highway shall be backfilled before leaving the work site for the night. After backfilling the trench, temporary surfacing shall be placed if required by State's representative.

Trench backfill shall conform to Section 19-3.06 of the State's Standard Specifications and the current edition of the Standard Plans. Tests for relative compaction of structure backfill material used in backfilling trenches may be made in accordance with Test Method No. California 231 (Nuclear gauge). Any base, surfacing or pavement shall be replaced in kind, or as otherwise required by State's representative.

All Permittee's personnel shall wear appropriate personal protective equipment, including hard hats and bright-colored vests, shirts or jackets with retro-reflective material while on State highway right-of-way.

All utility work shall be performed in accordance with the appropriate provisions contained in the Department of Transportation Encroachment Permit Utility Provisions dated July 2009.

Notwithstanding General Provision No.4, your contractor is required to apply for and obtain an encroachment permit prior to starting work and the application shall be accompanied by a check of \$ 1148 and a \$25,000.00 performance bond. The bond shall be in Caltrans bond form. Permittee's contractor shall be billed for any additional inspection cost at the current Caltrans rate of \$82.00/hr.

Immediately following completion of the work permitted herein, the permittee shall fill out and mail the notice of completion attached to this permit.

AS BUILT PLAN REQUIREMENTS:

Upon completion of the work provided herein, the permittee shall send one vellum or paper set of As-Built plans, to the State representative. Mylar or paper sepia plans are not acceptable. In addition, provide the State representative a complete set of acceptable full-sized reproducible As-Built plans on a CD-ROM (MicroStation.dgn file Release 5.0 or later) complying with STATE'S current CADD Users Manual and State's current Drafting and Plans Manual and all contract records, including survey documents and all corrected original full size structure plans.

All changes in the work will be shown on the plans, as issued with the permit, including changes approved by Encroachment Permit Rider. All changes to project plans and specifications or changes affecting State facilities shall be shown on As-Built plans.

The As-Built plans must also show all the detailed information required by paragraph 9.h of the Variance (00-V-RAR-02) issued by Department of Toxic Substances Control (DTSC) to State regarding the reuse of aerial deposited lead in soil within PROJECT limits.

Any relocated or new facilities shall be correctly shown and identified on the As-Built plans.

The plans are to be stamped or otherwise noted AS BUILT by the permittee's representative who was responsible for overseeing the work. Any original plan that was approved by a state stamp, or Caltrans representative signature, shall be used for producing the As-Built plans.

If "As-Built" plans include signing and striping, the dates of signing or striping removal, relocation or installation shall be shown on the plans when required as a condition of the permit. When the construction plans show signing and striping for Staged construction on separate sheets, the sheet for each stage shall show the removal, relocation or installation dates of the appropriate staged striping and signing.

As-Built plans shall contain the Permit Number, County, Route, Post Mile and Kilometer Post on each sheet.

Disclaimer statement of any kind, that differ from the obligations and protection provided by Sections 6735 through 6735.6 of the California Business and Professions Code, shall not be included on the As-Built plans. Such statements constitute non-compliance with Encroachment Permit requirements, and may result in the Department of Transportation retaining Performance Bonds or deposits until proper plans are submitted.

Failure to comply may result in denial of future permits, or a provision for a public agency to supply additional bonding.



Transmittal

City of Millbrae
Public Works Dept.
621 Magnolia Avenue
Millbrae, CA 94030
650.259.2339
Fax 650.697.8158

DATE: 10/12/12

TO: District 4 Encroachment Permit Office

Organization: Caltrans

Subject: Encroachment permit application for red light cameras on El Camino Real at Millbrae Avenue in Millbrae, San Mateo County.

SENT BY: Khee Lim, City Engineer

WE ARE SENDING via :

- | | | |
|---|---|---|
| <input checked="" type="checkbox"/> Enclosed | <input checked="" type="checkbox"/> For Your Review | <input type="checkbox"/> For Your Information |
| <input type="checkbox"/> Under Separate Cover | <input type="checkbox"/> For Your File | <input type="checkbox"/> For Your Signature |
| <input type="checkbox"/> As Requested | <input checked="" type="checkbox"/> For Your Approval | <input type="checkbox"/> Other |

THE FOLLOWING:

- Encroachment permit application for red light cameras on El Camino Real at Millbrae Avenue in Millbrae, San Mateo County.
- 6 sets of plans

STANDARD ENCROACHMENT PERMIT APPLICATION

TR-0100 (REV. 07/2007)

Permission is requested to encroach on the State Highway right-of-way as follows:
 (Complete all BOXES [write N/A if not applicable])

This application is not complete until all requirements have been approved.

FOR CALTRANS USE	
PERMIT NO.	0412-NSN 1764
DIST/CO/RTE/PM	04-SM-82 15.95
SIMPLEX STAMP	
04121764 SN DATE OF SIMPLEX STAMP OCT 15 2012	

1. COUNTY San Mateo		2. ROUTE 82	3. POSTMILE 15.95	
4. ADDRESS OR STREET NAME El Camino Real			5. CITY Millbrae	
6. CROSS STREET (Distance and direction from site) Millbrae Ave			7. PORTION OF RIGHT-OF-WAY Pavement and behind sidewalk.	
8. WORK TO BE PERFORMED BY <input type="checkbox"/> OWN FORCES <input checked="" type="checkbox"/> CONTRACTOR		9. EST. START DATE 10-22-12		10. EST. COMPLETION DATE 10-31-12
11. EXCAVATION	MAX. DEPTH 42"	AVG. DEPTH 42"	AVG. WIDTH 24"	LENGTH 24"
12. EST. COST IN STATE HIGHWAY RIGHT-OF-WAY \$50,000			FUNDING SOURCE(S) <input type="checkbox"/> FEDERAL <input type="checkbox"/> STATE <input type="checkbox"/> LOCAL <input checked="" type="checkbox"/> PRIVATE	
13. PIPES	PRODUCT TYPE PVC	DIAMETER 2"	VOLTAGE / PSIG 120V	14. CALTRANS PROJECT E.A. NUMBER

15. Double Permit Parent Permit Number _____
 Applicant's Reference Number / Utility Work Order Number _____

16. Have your plans been reviewed by another Caltrans branch? NO YES (If "YES") Who? _____

17. Completely describe work to be done within STATE highway right-of-way :
 Attach 6 complete sets of FOLDED plans (folded 8.5" x 11"), and any applicable specifications, calculations, maps, etc.
 All dimensions shall be in U.S. Customary (English) Units.

Install modifications to existing automatic red light enforcement system (ARLES). Work will include installing a new camera pole and camera equipment on the SE corner to replace a pole and equipment that was removed when the intersection was recently modified; installing new conductors in various existing ARLES conduits; installing new wireless vehicle detectors; installing current switches in a traffic signal pull box; replacing an existing ARLES pole and flash on the NW corner with a new taller pole and flash.

HR
 10/15/12
 CAC
 RR

18. Is a city, county, or other agency involved in the approval of this project?
 YES (If "YES", check type of project and attach environmental documentation and conditions of approval.)

- COMMERCIAL DEVELOPMENT BUILDING GRADING OTHER _____
 CATEGORICALLY EXEMPT NEGATIVE DECLARATION ENVIRONMENTAL IMPACT REPORT OTHER _____

NO (If "NO", please check the category below which best describes the project, and complete page 4 of this application.)

<input type="checkbox"/> DRIVEWAY OR ROAD APPROACH, RECONSTRUCTION, MAINTENANCE, OR RESURFACING	<input type="checkbox"/> FENCE
<input type="checkbox"/> PUBLIC UTILITY MODIFICATIONS, EXTENSIONS, HOOKUPS	<input type="checkbox"/> MAILBOX
<input type="checkbox"/> FLAGS, SIGNS, BANNERS, DECORATIONS, PARADES AND CELEBRATIONS	<input type="checkbox"/> EROSION CONTROL
<input checked="" type="checkbox"/> OTHER <u>Traffic signal modification</u>	<input type="checkbox"/> LANDSCAPING

19. Will this project cause a substantial change in the significance of a historical resource (45 years or older), or cultural resource?
 (If "YES", provide a description) YES NO

20. Is this project on an existing highway or street where the activity involves removal of a scenic resource including a significant tree or stand of trees, a rock outcropping or a historic building? YES NO (If "YES", provide a description)

21. Is work being done on applicant's property? YES NO (If "YES", attach site and grading plans.)

STANDARD ENCROACHMENT PERMIT APPLICATION

TR-0100 (REV. 07/2007)

PERMIT NO. _____

22. Will this proposed project require the disturbance of soil? YES NO
 If "YES", estimate the area within State Highway right-of-way in square feet AND acres: 5 (ft²) AND 0 (acres)
 estimate the area outside of State Highway right-of-way in square feet AND acres: 0 (ft²) AND 0 (acres)

23. Will this proposed project require dewatering? YES NO
 If "YES", estimate total gallons AND gallons/month: _____ (gallons) AND _____ (gallons/month)
 SOURCE*: STORM WATER NON-STORM WATER
 (*See Caltrans SWMP for definitions of non-storm water discharge: <http://www.dot.ca.gov/hq/env/stormwater/index.htm>)

24. How will any storm water or ground water be disposed of from within or near the limits of this proposed project?
 Storm Drain System Combined Sewer / Storm System Storm Water Retention Basin
 Other (explain): _____

PLEASE READ THE FOLLOWING CLAUSES PRIOR TO SIGNING THIS ENCROACHMENT PERMIT APPLICATION.

The applicant, understands and herein agrees to that an encroachment permit can be denied, and/or a bond required for non-payment of prior or present encroachment permit fees. Encroachment Permit fees may still be due when an application is withdrawn or denied, and that a denial may be appealed, in accordance with the California Streets and Highways Code, Section 671.5. All work shall be done in accordance with Caltrans rules and regulations subject to inspection and approval.

The applicant, understands and herein agrees to the general provisions, special provisions and conditions of the encroachment permit, and to indemnify and hold harmless the State, its officers, directors, agents, employees and each of them (Indemnitees) from and against any and all claims, demands, causes of action, damages, costs, expenses, actual attorneys' fees, judgments, losses and liabilities of every kind and nature whatsoever (Claims) arising out of or in connection with the issuance and/or use of this encroachment permit and the placement and subsequent operation and maintenance of said encroachment for: 1) bodily injury and/or death to persons including but not limited to the Applicant, the State and its officers, directors, agents and employees, the Indemnities, and the public; and 2) damage to property of anyone. Except as provided by law, the indemnification provisions stated above shall apply regardless of the existence or degree of fault of Indemnities. The Applicant, however, shall not be obligated to indemnify Indemnities for Claims arising from the sole negligence and willful misconduct of State, its officers, directors, agents or employees.

DISCHARGES OF STORM WATER AND NON-STORM WATER: Work within State Highway right-of-way shall be conducted in compliance with all applicable requirements of the National Pollutant Discharge Elimination System (NPDES) permit issued to the Department of Transportation (Department), to govern the discharge of storm water and non-storm water from its properties. Work shall also be in compliance with all other applicable Federal, State and Local laws and regulations, and with the Department's Encroachment Permits Manual and encroachment permit. Compliance with the Department's NPDES permit requires amongst other things, the preparation and submission of a Storm Water Pollution Protection Plan (SWPPP), or a Water Pollution Control Program (WPCP), and the approval of same by the appropriate reviewing authority prior to the start of any work. Information on the requirements may also be reviewed on the Department's Construction Website at:

<http://www.dot.ca.gov/hq/construc/stormwater/stormwater1.htm>

25. NAME of APPLICANT or ORGANIZATION (Print or Type) <u>City of Millbrae</u>		E-MAIL ADDRESS <u>klim@ci.millbrae.ca.us</u>	
ADDRESS of APPLICANT or ORGANIZATION WHERE PERMIT IS TO BE MAILED (Include City and Zip Code) <u>621 Magnolia Avenue, Millbrae, CA 94030</u>			
PHONE NUMBER <u>650 259 2347</u>		FAX NUMBER <u>650 697 8158</u>	
26. NAME of AUTHORIZED AGENT / ENGINEER (Print or Type) <u>Khee Lim</u>		IS LETTER OF AUTHORIZATION ATTACHED? <input type="checkbox"/> YES <input checked="" type="checkbox"/> NO	E-MAIL ADDRESS <u>SAME AS ABOVE</u>
ADDRESS of AUTHORIZED AGENT / ENGINEER (Include City and Zip Code) _____			
PHONE NUMBER _____		FAX NUMBER _____	
27. SIGNATURE of APPLICANT or AUTHORIZED AGENT <u>Khee Lim</u>	28. PRINT OR TYPE NAME <u>Khee Lim</u>	29. TITLE <u>Associate Engineer</u> <u>City</u>	30. DATE <u>10-12-2012</u>

PERMIT NO. _____
WORK ORDER/REFERENCE NUMBER _____

FEE CALCULATION -- FOR CALTRANS USE					
<input type="checkbox"/> CASH <input type="checkbox"/> CREDITCARD NAME ON CARD _____ PHONE NUMBER _____					
<input type="checkbox"/> CHECK NUMBER _____ NAME ON CHECK _____ PHONE NUMBER _____					
<input type="checkbox"/> EXEMPT <input type="checkbox"/> PROJECT EA _____ <input type="checkbox"/> DEFERRED BILLING (Utility)					
CALCULATED BY	(1)		(2)		
REVIEW	1. FEE / DEPOSIT	DATE	2. FEE / DEPOSIT	DATE	TOTAL FEE / DEPOSIT
1. _____ HOURS @ \$ _____ *	\$ _____		\$ _____		\$ _____
2. _____ HOURS @ \$ _____ *			\$ _____		\$ _____
INSPECTION	1. FEE / DEPOSIT	DATE	2. FEE / DEPOSIT	DATE	TOTAL FEE / DEPOSIT
1. _____ HOURS @ \$ _____ *	\$ _____		\$ _____		\$ _____
2. _____ HOURS @ \$ _____ *			\$ _____		\$ _____
FIELDWORK					
_____ HOURS @ \$ _____ *	\$ _____		\$ _____		\$ _____
EQUIPMENT & MATERIALS	DEPOSIT	DATE	DEPOSIT	DATE	DEPOSIT
	\$ _____		\$ _____		\$ _____
CASH DEPOSIT IN LIEU OF BOND	\$ _____		\$ _____		\$ _____
TOTAL COLLECTED	\$ _____		\$ _____		
CASHIER'S INITIALS	_____		_____		\$ _____
* The current hourly rate is set annually by Headquarters Accounting. District Office staff do not have authority to modify this rate.					
PERFORMANCE BOND	<input type="checkbox"/>	DATE			AMOUNT \$
PAYMENT BOND	<input type="checkbox"/>	DATE			AMOUNT \$
LIABILITY INSURANCE REQUIRED?		<input type="checkbox"/> YES <input type="checkbox"/> NO			AMOUNT \$

STANDARD ENCROACHMENT PERMIT APPLICATION

TR-0100 (REV. 07/2007)

PERMIT NO. _____

INSTRUCTIONS
for completing page 4

This page needs to be completed when the proposed project DOES NOT involve a City, County or other public agency.

Your answers to these questions will assist departmental staff in identifying any physical, biological, social or economic resources that may be affected by your proposed project within the State highway right-of-way. And, to determine which type of environmental studies may be required to approve your application for an encroachment permit.

It is the applicant's responsibility for the production of all required environmental documentation and supporting studies, in some cases this may be costly and time-consuming. If possible, attach photographs of the location of the proposed project.

Please answer these questions to the best of your ability. Provide a description of any "YES" answers (type, name, number, etc.)

-
1. Will any existing vegetation and/or landscaping within the highway right-of-way be disturbed?

No.

-
2. Are there waterways (e.g. river, creek, pond, natural pool or dry streambed) adjacent to or within the limits of the project or highway right-of-way? No.

-
3. Is the proposed project located within five miles of the coast line?

Yes.

-
4. Will the proposed project generate construction noise levels greater than 86 dBA (e.g. jack-hammering, pile driving)?

No.

-
5. Will the proposed project incorporate land from a public park, recreation area or wildlife refuge open to the public?

No.

-
6. Are there any recreational trails or paths within the limits of the proposed project or highway right-of-way?

No.

-
7. Will the proposed project impact any structures, buildings, rail lines, or bridges within highway right-of-way?

No.

-
8. Will the proposed project impact access to any businesses or residences?

No.

-
9. Will the proposed project impact any existing public utilities or public services?

No.

-
10. Will the proposed project impact existing pedestrian facilities, such as sidewalks, crosswalks, or overcrossings?

No.

-
11. Will new lighting be constructed within or adjacent to highway right-of-way?

No.

Permit No.

0412-NSN1764



Dist/Co/Rte/PM

04-SM-82 15.95

In compliance with (*Check one*):

- Your application of October 16, 2012
- Utility Notice No. _____ of _____
- Agreement No. _____ of _____
- R/W Contract No. _____ of _____

Date

January 16, 2013

Fee Paid

Deposit

\$

Performance Bond Amount (1)

Payment Bond Amount (2)

Bond Company

Bond Number (1)

Bond Number (2)

TO: City of Millbrae
 621 Magnolia Avenue
 Millbrae, CA 94030

Attn: Khee Lim

Phone: (650) 259-2347

, PERMITTEE

And subject to the following, **PERMISSION IS HEREBY GRANTED** to:

Modify existing Automatic Red Light Enforcement System (ARLES) on State Highway 04 SM-82, Postmile 15.95, at Millbrae Avenue in the City of Millbrae.

A minimum of one week prior to the start of work under this permit, notice shall be given and advance approval of construction detail, operation, public safety and traffic control shall be obtained from State Representative, Fred Farid, 380 Foster City Blvd., Foster City, 94404, (415) 330-6537 weekdays, between 7:30 AM and 4:00 PM.

All permitted work requires the permittee to apply for and obtain a work authorization number prior to the start of work. See the attached "Encroachment Permit Project Work Scheduling Procedures" and the attached "Permit Project Work Scheduling Request Form". Additional time beyond the minimum seven day advanced notice required in the above paragraph may be required for obtaining approval.

The following attachments are also included as part of this permit (*Check applicable*):

- Yes No General Provisions
- Yes No Utility Maintenance Provisions
- Yes No Storm Water Special Provisions
- Yes No A Cal-OSHA permit required prior to beginning work:

In addition to fee, the permittee will be billed actual costs for:

- Yes No Review
- Yes No Inspection
- Yes ----- Field Work

(If any Caltrans effort expended)

Yes No The information in the environmental documentation has been reviewed and considered prior to approval of this permit.

This permit is void unless the work is completed before June 30, 2013

This permit is to be strictly construed and no other work other than specifically mentioned is hereby authorized. No project work shall be commenced until all other necessary permits and environmental clearances have been obtained.

CAC

cc: RS (2), M. Movassat
 DTM/P. Chan, TMC/J. Richardson

APPROVED:

BIJAN SARTIPI, District Director

BY:

David Salladay
DAVID SALLADAY, District Permit Engineer

NAME: City of Millbrae
PERMIT NO. 0412-NSN1764
DATE: January 18, 2013

When approved, traffic control performed under this permit shall be in accordance with the appropriate State Standard Plans T-10 through T-14. Where required by the plan, the use of a flashing arrow-board is MANDATORY.

Sidewalk may be closed while work is actively in progress.

On Southbound 82 (El Camino Real), one lane may be closed from 9:00 AM to 3:00 PM, Monday thru Friday. See Standard Plan T-11.

Holidays excluded.

No other closure permitted.

All workers shall wear appropriate personal protective equipment, including hard hats and lime green protective vests, shirts, or jackets as appropriate, while on State Highway right of way.

Any damage to existing facilities, landscaping or irrigation, signal/electrical facilities within the State's Right of Way shall be replaced in kind by the permittee at permittee's expense.

Notwithstanding General Provision No. 4, your contractor is required to apply for and obtain an encroachment permit prior to starting work.

Immediately following completion of the work permitted herein, the permittee shall fill out and mail the Notice of Completion attached to this permit.